

# European 17 Larvik – Illustrated text

## Larvik - Kystbyen

### Introduction to the project

#### Introduction to the project

Larvik's town centre is uniquely situated between Farrisvannet in the north-west and Larviksfjorden towards the south-east. There are several interesting green areas close to the town centre today, such as the well renowned Bøkeskogen and Bøkkerfjellet. However, in today's situation, the town centre, Torget, and the harbour are divided by both infrastructure and a steep topography. Because of this, the waterfront is not easily accessed from town centre and the waterfront's qualities are not used to its potential.

Larvik is fundamentally connected to the water. Our proposal, Kystbyen, sees great prospect in developing the harbour's integrity in the town centre. The project takes aim in two parts: to extend the town to the waterfront, Bøkkerfjell-connections, and to make a new, cultural, and public harbour-square, Folkehavna. Our vision is to show Larvik's waterfront as a space for everyone through different strategies which can both be developed singularly and all together. Main ideas of the project are Bøkkerheisen and Havnebiblioteket. Given the proximity to central infrastructure such as the train, Storgata and water access, the project serves as a unique opportunity to attract tourism to Larvik, which can have positive effects on the town's economical sustainability and social life.

Our process aims to make flexible strategies to be further discussed and evolved during the workshop-phase following the competition to best meet the interests of the people of Larvik. We believe spaces, functions, and services like the ones we propose, are best developed with the people, rather than from the top down.

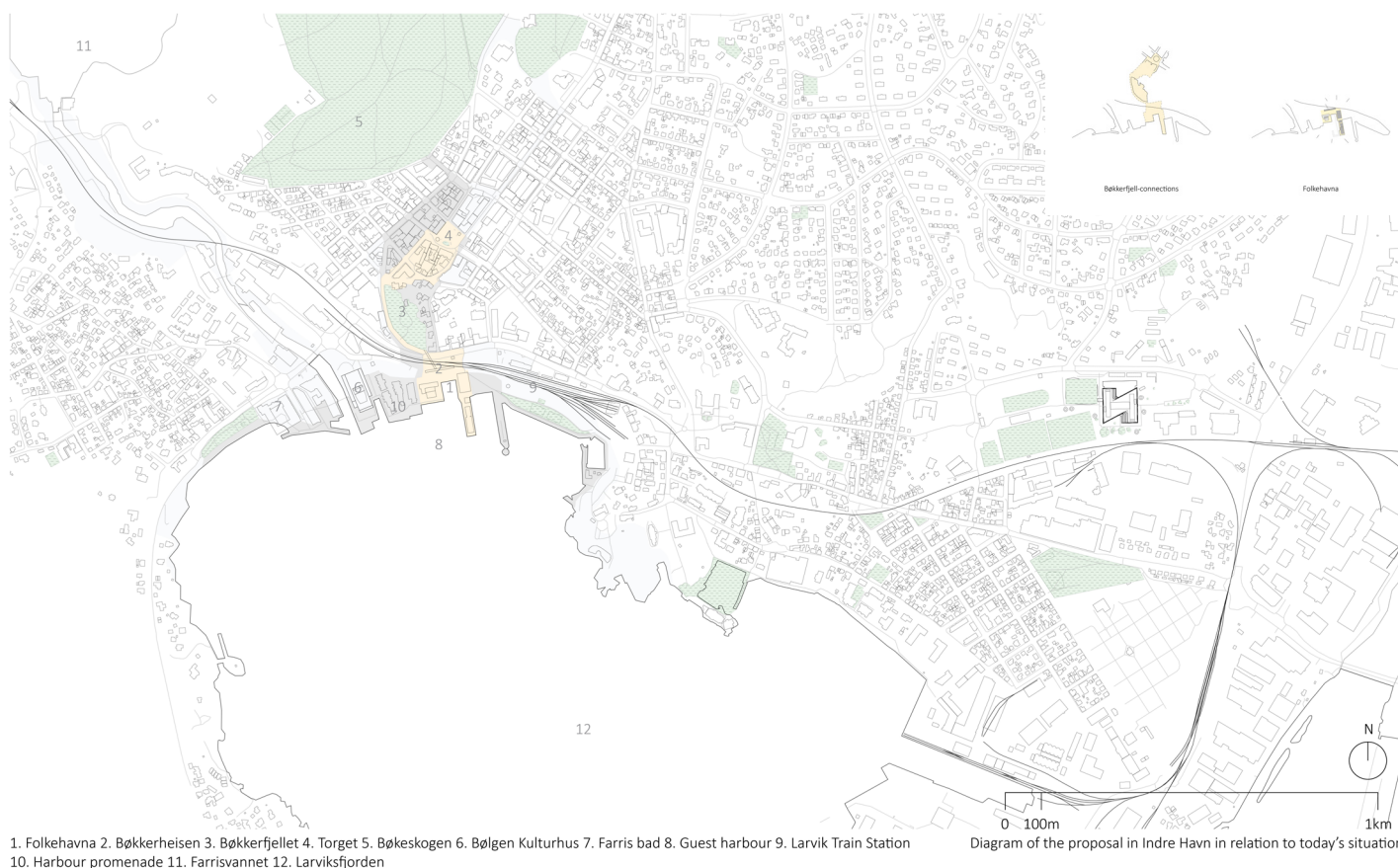

## The Bøkkerfjell-connections

Walking from Bøkkerfjellet towards Bøkkerheisen.

Today there are several new, cultural, residential, and commercial projects down by the waterfront which all see great value in the quality of being so close to the fjord. However, they are partially fragmented in the townscape and do little new to solve the crossing of the train tracks and the steep topography towards the town centre. We believe its central for Larvik's development to introduce new and innovative solutions to improve on this connection, and we see unique opportunity to respectfully use Bøkkerfjellet and the immediate surroundings for this. We seek to use Bøkkerfjellet and Bøkkerveien, as main veins for extending the town centre to the harbour in three different strategies:

### Grønne gater

Make a clear green connection from Torget through, Bredochs gate, Feyers gate and Brannvaktsgate, to Bøkefjellet. This will strengthen the existing connection between Torget and Bøkefjellet.

### Bøkkerheisen

Create a direct and contemporary connection between Bøkkerfjellet and the harbour as a universally accessible connection. Bøkkerheisen will become a scenic path approximately 22 meters up in the air and accessible by foot from Bøkkerfjellet and connected to the harbour with stairs and a lift. The connection attempts to not be intrusive but rather complementary to its situation with a design which is beautiful in its simplicity and with no connection points (no columns), spanning between Bøkkerfjellet and the lift/stair-shaft. A new landmark in Larvik symbolizing that Larvik is a town for everyone.

### Bakkeveiene

To extend the town centre down towards the harbour, it is important to make strategies for more than only one singular point. Today there are several paths with qualities around Bøkkerfjellet, such as the Bøkkerveien and the stairway going up to the mountain. We seek to highlight them as alternative bicycle and pedestrian paths from the centre to the harbour. These connections demand an improved train crossing compared to the existing situation. Widening the train crossing have great potential in making a visible access from Storgata to the harbour.



## Folkehavna

Our project aims to develop the site as a public zone designated for people and cyclists. We see a potential for the site to become an integral public, social and cultural square by the Larvik waterfront. To do so, we suggest a respectful transformation which attempts to add or improve on the existing situation with several different strategies which can be developed independently of one another.

### Define Folkehavna

In order to define the zone as a new space for people and cyclists, we suggest strategies which will make a perimeter: To make an 'urban carpet' and create a green zone between the harbour and the train tracks. In order to create a focal point for this defined place, we propose to reconstruct the waterfront to the harbour-pool which has historically been there, as also proposed in the county-plans.

### Folkehavna as a central town node

To comply with our vision for accessibility it is important that Folkehavna acts as a central node for the town as it connects the harbour and the inner city.

### Transform existing buildings for future use

The Custom buildings and Pakkhuset are historically and socially important buildings. We the buildings should be renovated or transformed for future use. In order to make the Custom-buildings universally accessible and better for general use, we propose a minimalistic connection-building between the two. We see the existing Tollkammeret as a potentially new Visitors centre for tourists.

### Build new public buildings/structures

A very central part of the transformation of the harbour is to find out what services, functions and activities can potentially be put on the site to make it an attractive square and space for everyone. For this we propose three new building/structure-proposals which will make Folkehavna a beautiful and important place for the people of Larvik.

### Havnebiblioteket

Today Larvik lacks a library that provides sufficient spaces for future use. Because of the complicated situation regarding the future of the train-tracks and where they are going to be positioned, we believe it is a good idea to begin building a new library by the waterfront. This highlighted public building has the potential of becoming a catalyst for the future Larvik harbour as an attractive and public area. We also see great qualities in the connection between a library as a cultural institution and the generous outdoor spaces by the waterfront, making it a desirable building for people to visit.

### Havnebassenget

We believe the site's waterfront serves well as a public dock for leisure-activities by the water such as sitting by the water, swimming in the fjord, diving, saunas and boat docking.



# PRINCIPLES FOR FOLKEHAVNA

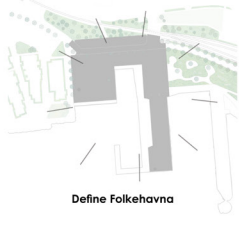

Define Folkehavna



Folkehavna as a central town node

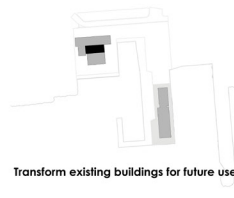

Transform existing buildings for future use

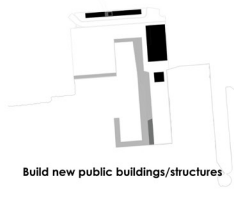

Build new public buildings/structures

